

REAR AXLE SHAFT (Semi-floating Type)

COMPONENTS

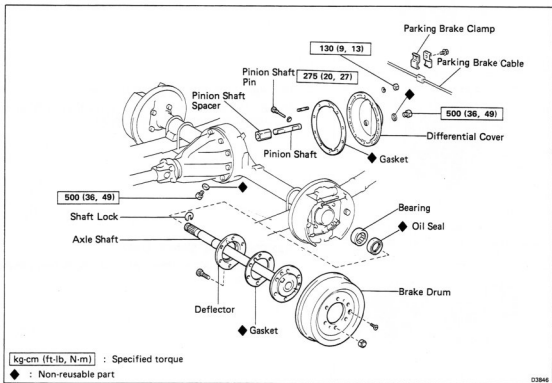

03946

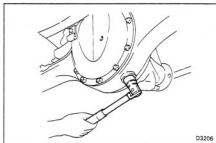

REMOVAL OF REAR AXLE SHAFT

1. JACK UP AND SUPPORT VEHICLE
2. REMOVE WHEEL AND BRAKE DRUM
3. REMOVE DRAIN PLUG AND DIFFERENTIAL OIL
4. REMOVE PARKING BRAKE CABLE CLAMP
5. REMOVE DIFFERENTIAL COVER
 - (a) Remove the ten nuts and washer.
 - (b) Remove the differential cover with gasket.

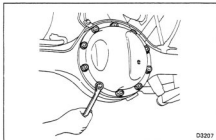

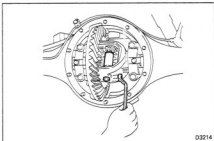

6. REMOVE PINION SHAFT AND PINION SPACER

- (a) Remove the pinion shaft pin from the differential.

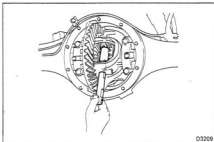

- (b) Remove the pinion shaft and spacer.

NOTE: When the pinion shaft is removed, the pinion gear and thrust washer will come off also.

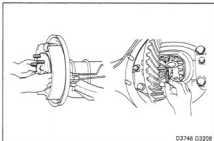

7. REMOVE AXLE SHAFT LOCK

Push the axle shaft to the differential side and remove the axle shaft lock.

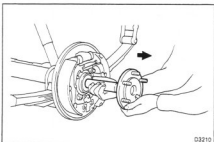

8. REMOVE AXLE SHAFT

CAUTION: When pulling out the axle shaft, be careful not damage the oil seal.

INSPECTION AND REPLACEMENT OF REAR AXLE SHAFT COMPONENTS

1. INSPECT REAR AXLE SHAFT

- Check for wear or damage.
- Check the runout of axle shaft.

Maximum runout: 0.8 mm (0.031 in.)

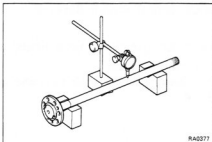

2. INSPECT OIL SEAL AND BEARING FOR WEAR OR DAMAGE

If the oil seal and bearing is damaged or worn, replace it.

3. REPLACE OIL SEAL AND BEARING

- Using SST, remove the oil seal.

SST 09308-00010

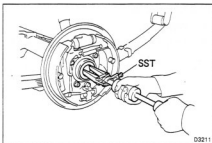

- Using SST, remove the bearing.

SST 09514-35011

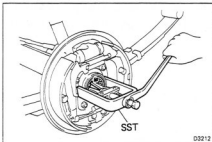

- Apply MP grease to the bearing.

- Using SST, drive in the bearing.

SST 09608-20011

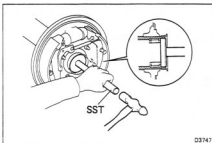

- Using SST, drive in the oil seal.

SST 09608-20011

- Apply MP grease to the oil seal lip.

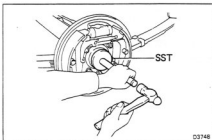

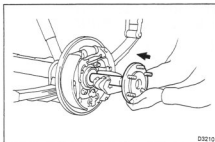

03210

INSTALLATION OF REAR AXLE SHAFT

(See page RA-3)

1. INSTALL REAR AXLE SHAFT IN AXLE HOUSING

Insert the axle shaft into the housing.

CAUTION: When inserting the axle shaft, be careful not to damage the oil seal.

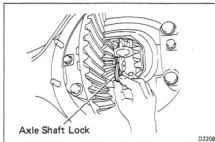

Axle Shaft Lock

03208

2. INSTALL AXLE SHAFT LOCK

(a) Install the axle shaft lock to the axle shaft.

(b) Pull the axle shaft fully toward the outer side of vehicle.

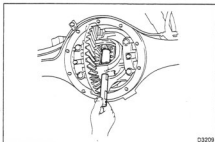

03209

3. INSTALL PINION SHAFT AND PINION SPACER

(a) Install the spacer and pinion shaft to the differential.

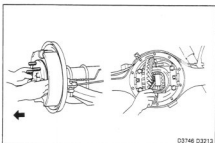

03746 03213

(b) Measure the thrust clearance between the axle shaft and spacer.

Maximum clearance 0.5 mm (0.020 in.)

If necessary, select the spacer.

Spacer thicknesses

Thickness	mm (in.)
29.0	(1.142)
29.4	(1.157)
29.8	(1.173)
30.2	(1.189)
30.6	(1.205)

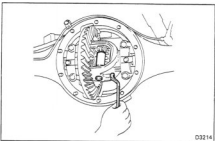

03214

(c) Install the pinion shaft pin.

Torque: 275 kg-cm (20 ft-lb, 27 N·m)

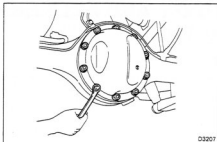
**4. INSTALL DIFFERENTIAL COVER**

(a) Install the new gasket and differential cover to the axle housing.

(b) Install the ten nuts and washers.

Torque: 130 kg-cm (9 ft-lb, 13 N·m)

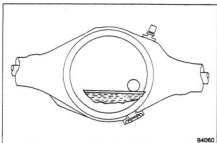
5. INSTALL PARKING BRAKE CABLE CLAMP**6. INSTALL BRAKE DRUM AND WHEEL****7. FILL DIFFERENTIAL WITH GEAR OIL**

Hypoid gear oil: API GL-5

Above -18°C (0°F) SAE90

Below -18°C (0°F)

SAE 80W or 80W-90

Capacity: 2.5 liters (2.6 US qts, 2.2 Imp. qts)

NOTE: With LSD fill in hypoid gear oil
LSD, SAE 90 API GL-5

8. LOWER VEHICLE